



Application range

- **Traffic data acquisition: number of vehicles, vehicle lengths, vehicle speed, occupancy time, net time gap**
- **Incident detection: traffic jam, accident, wrong driver, smoke**
- **Mobile and stationary installation**
- **Control of traffic lights, data acquisition in cities and on highways, tunnel monitoring**
- **Automatic analysis of traffic data and incidents**

Advantages

- **Overhead detection, therefore no roadworks**
- **Fast and easy installation and configuration**
- **Remote configuration**
- **Manufacturer-independent implementation**

Features

- **Integrated solution: camera and detector in one enclosure**
- **Highly precise measurement results**
- **Programming of up to 32 detectors**
- **Color CCD camera 1/4" with infrared filter**
- **Software-controlled 16x hardware zoom**
- **Integrated grabber function and real-time video image transmission**
- **Easy calibration and system adjustment**
- **Evaluation of the data with e.g. EXCEL or other programmes**
- **Pressurized enclosure with sun shield and integrated faceplate heater**
- **Easy connection and network configuration via communication module (ComPanel)**

Function description

The video detection system SoloPro detects traffic incidents, analyses via software-algorithm the video image and establishes the requested traffic data. It can be used for traffic analysis, traffic management and signal control at nodal points.

Because of the integrated solution of detector and camera in one enclosure, the complete detection and analyses of the video image takes place within the camera. Only the actual traffic data is transmitted via RS485 data interface to a PC or main computer. This saves complex video wiring and allows a mobile application.

Programming

SoloPro is parameterised by means of a PC. With the user-friendly software the user can “install” virtually the sensors / loops onto the detecting lanes directly on screen. Several types of virtual sensors e.g. for counting, speed, traffic jam, vehicle length are available.

Application motorway

With the SoloPro system traffic data acquisition can be realised for all lanes including the parking lane. Therefore, not only traffic volume or speed can be detected, but also the reliable traffic jam identification and detection of neglected vehicles can be implemented. All data can be locally stored for later analysis or can be transmitted via data line to the main traffic control computer.

Application traffic light

The SoloPro system can be used at traffic lights for presence detection, traffic jam detection, green-phase rating and counting.

Optionally available:

- **Video image compression card** for optimal and quick transmission of digital video images via existing communication channels.
- **Pan-tilt mode** for remote control of the pan-tilt unit for combined (multifunctional) detection and surveillance requirements via serial interface.

□ Technical Data / Function

Power supply:	24 V AC, 50 / 60 Hz (10 – 28) V DC 20 W if heating on, 15 W if heating off
Communication:	installed RS485 interface optional additional serial interface
Protection class:	IP 66
Dimensions:	Height: 100 mm, Width: 120 mm, Length: 540 mm
Weight:	2.7 kg
Working temperature range:	-40°C to +60°C 0 % to 95 % relative humidity, non-condensing

□ Technical Data / Conformity

Safety, Health:	ELV (safety extra low voltage)
EMC:	CE EN 55011, EN 61000-6-2, according to directive 89/336/EEC
Radio:	not applicable

Dimensions

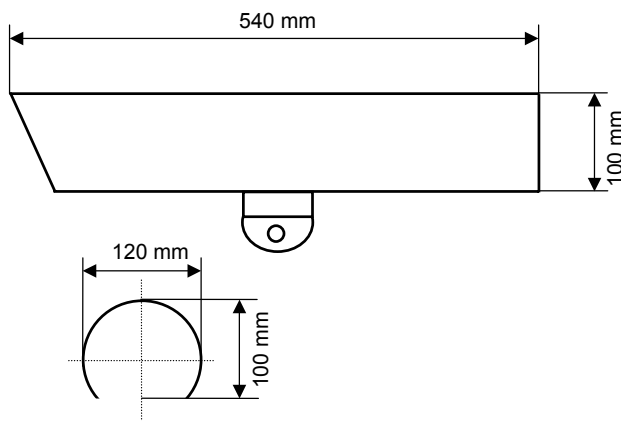

Measurements are subject to manufacturer's tolerances!

Pin assignment to ComPanel

Lead	Function (signal)	ComPanel (clamp)
A	24 V AC	1
B	24 V AC	2
N	Ground PE	3
P	Supervisor RX+	4
U	Supervisor RX-	5
D	Supervisor TX+	6
R	Supervisor TX-	7
F	Det +	8
E	Det -	9
J	Video +	10
H	Video -	11